

SELF LOADING PADDING MACHINE

SPD - 250 EVO

Transport dimensions: 11,3/37.1(L) X 3,0/9.8(W) X 3,45/ 11.3(H) [m/ft]
 Transport weight: 29000 / 63800 [kg/lb]

Operation dimensions

L1	9,8 m	35 ft
L2	3,45 m	12.3 ft
L3	2,55 m	9.97 ft
L4	2,95 m	11 ft
L5	2,55 m	10.7 ft
L6	2,72 m	8.8 ft
L7	11,30 m	39 ft
H1 min	0,7 m	10.8 ft
H1 max	2,0 m	10.8 ft
H2	4,3 m	13.5 ft
H3	0,5 m	1.6 ft
S1	0,55 m	2.0 ft

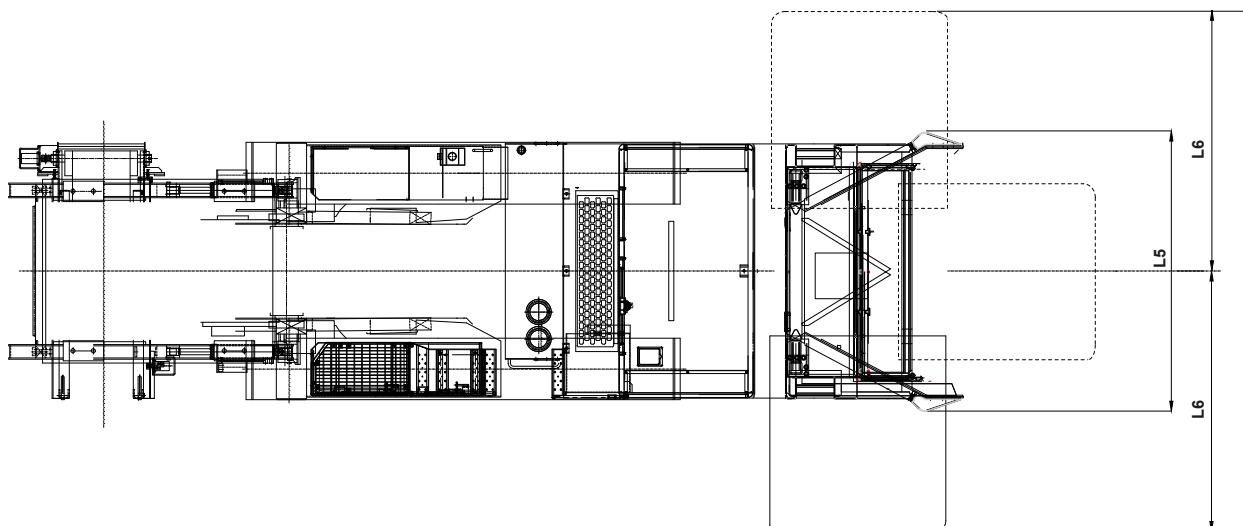
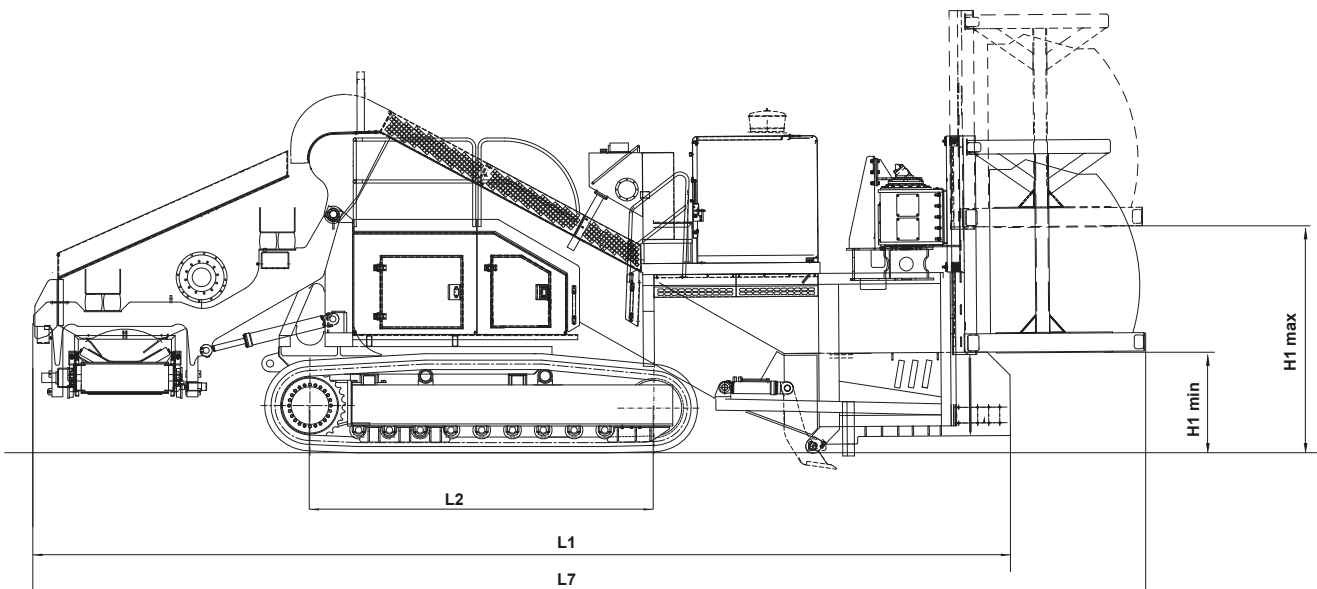
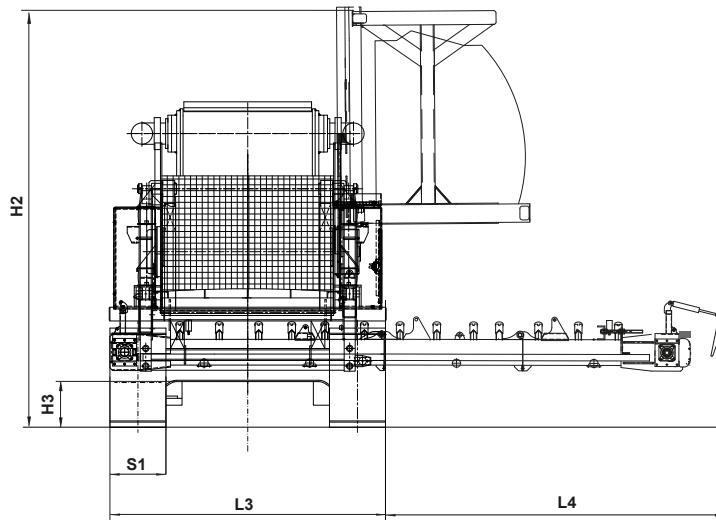



ENGINE

EMISSION US EPA&CARB Tier 3 / EU Stage IIIA	
Type:	Caterpillar
Model:	C7.1
Net flywheel power (DIN 6270-SAEJ 1349):	250 HP - 187 kW
Governed speed:	2100 rpm
Displacement:	7 l

EMISSION US EPA&CARB Tier 4 FINAL / EU Stage V	
Type:	Caterpillar
Model:	C7.1
Net flywheel power (DIN 6270-SAEJ 1349):	250 HP - 187 kW
Governed speed:	2100 rpm
Displacement:	7 l



HYDRAULIC SYSTEM

<u>Transmission Pumps</u>	
Doble axial piston pumps, variable displacement	
Maximum flow:	177 l/min
Maximum operating pressure:	420 bar
<u>Escalator Pumps</u>	
Axial piston pumps, variable displacement	
Maximum flow:	110 l/min
Maximum operating pressure:	300 bar
<u>Service Pumps</u>	
Axial piston pumps, variable displacement	
Maximum flow:	95 l/min
Maximum operating pressure:	320 bar
Tandem	
Maximum flow:	74 + 21 l/min
Maximum operating pressure:	180 + 150 bar
Single	
Maximum flow:	40 l/min
Maximum operating pressure:	200 bar



TRANSMISSION

Type	Hydrostatic
Motor	Axial piston, 1 speed, integrated
Brakes	Integrated multiple disk brake, negative control
Final Drive	Planetary, in oil bath
Max. Speed	4,5 km/h - 2.8 miles/hr



PERFORMANCE

Operating weight:	29.000 kg - 64,000 lb
Working max. grade ability (loadless)	
Uphill/downhill:	57% - 30°
Side hill:	5% - 3°



TRACKED CARRIAGE

Bottom Rollers	8 Per Side
Top Rollers	2 Per Side
Track Gauge	2.000 mm - 79 in
Pitch	3.450 mm - 135.8 in
Shoe Material	Steel
Shoe Width	550 mm - 15.75 in
Area In Contact With Ground	37.950 cm ² - 14,941 Sq.in
Specific Pressure On Ground	0.76 Kg/cm ² - 4.2 lb/Sq.in



ESCALATOR

Type:	Hydrostatic, variable speed
Brakes:	2 integrate negative control
Final drives:	Planetary, in oil bath
Rotation:	Reversible
Shoes	990 mm - 39 in



UNLOADING CONVEYOR

Type	Two-Side Belt With Hydraulically-Controlled Extension
Belt Type	Rubber
Rotation	Reversible
Width	600 mm - 23.6 In
Length	5.500 mm - 216.5 In
Variable Speed	0-420 m/Min
Transmission	Hydrostatic, Variable Speed
Hydraulic motor	Type 2, Orbital



SCREEN

Type	Hydrostatic
Interchangeable Mesh	From 1/2" To 4" (Other Mesches Type On Demand)
Width	1200 mm - 47.2 In
Length	2320 mm - 91 In
Area	2,8.m ² - 30 Sq Ft
No. Screening Levels	1
Max. Speed	1260 rpm



CONTROLS

Track controls type:	Joystick-electric over hyd.
Service controls type:	Joystick-electric over hyd.
Safety controls	Emergency shut-off
Camera	Rear with 7" display



FLUID CAPACITIES

Fuel tank:	365 l - 96 U.S.gal
Def tank:	32 l - 8.5 US gal
Hydraulic oil tank:	440 l - 116 U.S.gal



ELECTRIC SYSTEM

Operating voltage:	24 V
Maintenance free supplied batteries:	2
Capacity (total):	2X180 Ah
Starter capacity:	5,5 kW
Alternator:	80 A
Remote control	



CABIN

- Liftable up/down.
- Swivable 90° clockwise or counterclockwise.
- Elastically suspended cab.
- Operator's seat and jump seat.
- Sound proof.
- Air conditioning
- ROPS EN ISO 3471 support frame.



OPTIONAL

Auto levelling system