

SELF LOADING PADDING MACHINE

SPD - 450 EVO

Transport dimensions: 12,95/42.5(L) X 3,8/12.5(W) X 3,8/12.5 (H) [m/ft]

Transport weight: 55.200 / 121,440 [kg/lb]

Operating dimensions

L1	11,75 m	38.5 ft
L2	4,70 m	15.4 ft
L3	3,75 m	12.3 ft
L4	3,95 m	13 ft
L5	4,10 m	13.5 ft
L6	3,09 m	10.2 ft
L7	12,95 m	42.5 ft
H1 min	0,60 m	2 ft
H1 max	2,60 m	8.5 ft
H2	4,13 m	13.55 ft
H3	0,52 m	1.7 ft
S1	0,7 m	2.3 ft

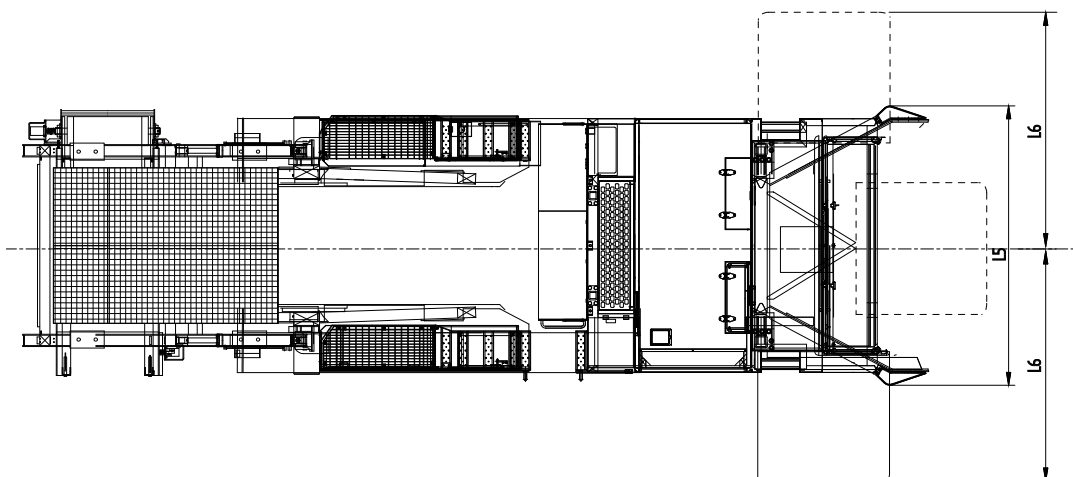
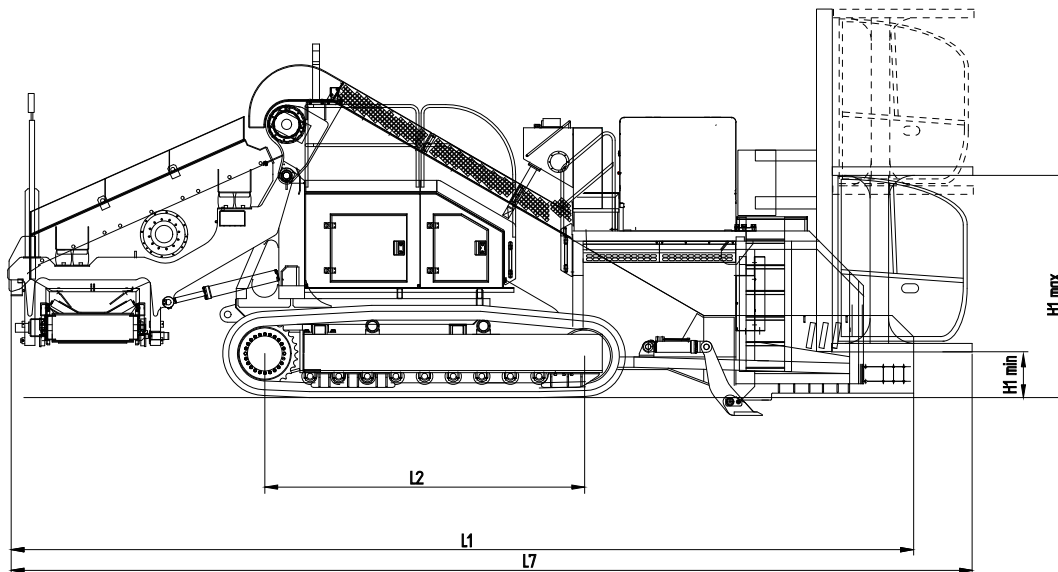
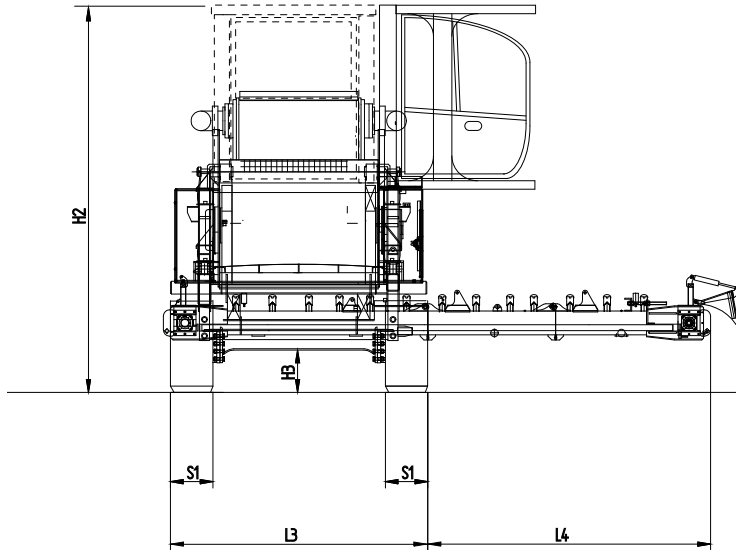



ENGINE

EMISSION US EPA&CARB Tier 3 / EU STAGE IIIA	
Type:	Caterpillar
Model:	C13 ACERT
Net flywheel power (DIN 6270-SAEJ 1349):	440 HP - 328 kW
Governed speed:	2200 rpm
Displacement:	12.5 l



ENGINE

EMISSION US EPA&CARB Tier 4 FINAL / EU STAGE V	
Type:	Caterpillar
Model:	C13 ACERT
Net flywheel power (DIN 6270-SAEJ 1349):	440 HP - 328 kW
Governed speed:	2200 rpm
Displacement:	12.5 l



HYDRAULIC SYSTEM

<u>Transmission Pumps</u>	
Doble axial piston pumps, variable displacement	
Maximum flow:	250 l/min
Maximum operating pressure:	320 bar
<u>Escalator Pumps</u>	
Axial piston pumps, variable displacement	
Maximum flow:	250 l/min
Maximum operating pressure:	280 bar
<u>Service Pumps</u>	
Axial piston pumps, variable displacement	
Maximum flow:	150 l/min
Maximum operating pressure:	280 bar
Tandem	
Maximum flow:	65 + 44 l/min
Maximum operating pressure:	180 + 150 bar
Single	
Maximum flow:	40 l/min
Maximum operating pressure:	200 bar



TRANSMISSION

Type	Hydrostatic
Motor	Axial piston, 1 speed, integrated
Brakes	Integrated multiple disk brake, negative control
Final Drive	Planetary, in oil bath
Max. Speed	4,5 km/h - 2.8 miles/hr



PERFORMANCE

Operating weight:	55.200 kg - 121,700 lb
Working max. grade ability (loadless)	
Uphill/downhill:	57% - 30°
Side hill:	5% - 3°



TRACKED CARRIAGE

Bottom Rollers	10 Per Side
Top Rollers	2 Per Side
Track Gauge	3.050 mm - 120 in
Pitch	4.070 mm - 160 in
Shoe Material	Steel
Shoe Width	700 mm - 27.5 in
Area In Contact With Ground	56.980 cm ² - 8,832 Sq.in
Specific Pressure On Ground	0.95 Kg/cm ² - 13,5 lb/Sq.in



ESCALATOR

Type:	Hydrostatic, variable speed
Brakes:	2 integrate negative control
Final drives:	Planetary, in oil bath
Rotation:	Reversible
Shoes	1980 mm - 78 in



UNLOADING CONVEYOR

Type	Two-Side Belt With Hydraulically-Controlled Extension
Belt Type	Rubber
Rotation	Reversible
Width	900 mm - 35 in
Length	7.800 mm - 307 in
Variable Speed	0-230 m/min
Transmission	Hydrostatic, Variable Speed
Hydraulic motor	Type 2, Orbital



SCREEN

Type	Hydrostatic
Interchangeable Mesh	From 1/2" To 4" (Other Mesches Type On Demand)
Width	2400 mm - 94.5 in
Length	3070 mm - 120.1 In
Area	8 m ² - 86 Sq Ft
No. Screening Levels	1
Max. Speed	1050 rpm



CONTROLS

Track controls type:	Joystick - electric over hyd.
Service controls type:	Joystick - electric over hyd.
Safety controls	Emergency shut-off
Camera	Rear with 7" display



FLUID CAPACITIES

Fuel tank:	725 l - 193 U.S.gal
Def tank:	33.6 l - 8.9 US gal
Hydraulic oil tank:	785 l - 209 U.S.gal



ELECTRIC SYSTEM

Operating voltage:	24 V
Maintenance free supplied batteries:	2
Capacity (total):	2X180 Ah
Starter capacity:	7,5 Kw
Alternator:	65 A
Remote control	



CABIN

- Lifiable with stroke 1300 mm.
- Swivable 90° clockwise or counterclockwise.
- Elastically suspended cab.
- Operator's seat and jump seat.
- Sound proof.
- Air conditioned
- Horn.
- Additioned with protection ROPS EN ISO 3471:2008.



OPTIONAL

Auto lveling system